

ACCESSORIES FOR DISTRIBUTION FRAMES



PK-19

PK-19 SHELF

- installation in 19" racks and cabinets
- pigtail and patchcord excess cable lengths storage, support for measuring equipment
- dimensions: 483x250x44(1U), 88(2U) mm
- heights: 1U, 2U



TP-19/12

TP-19/12 19" ADAPTER FRONT PLATE

- installation in 19" racks and cabinets
- capacity: 12 x E-2000 or SC adapters
- dimensions: 483/44(1U) mm



AD-19/21/2U

ADAPTER AD-19/21 AD-19/23

- allows installation of 19" panels in 21" or 23" racks or cabinets
- heights: 1U, 2U, 3U

ADAPTER AD-19/21/1U/30 AD-19/21/2U/30

- allows installation of 19" panels in 21" racks or cabinets, front plates shifted back by 30 mm
- heights: 1U, 2U



AD-19/21/2U/30

ADAPTER AD-19/19/1U/50

- allows installation of 19" panels in 19" racks or cabinets, front plates shifted back by 50 mm
- heights: 1U

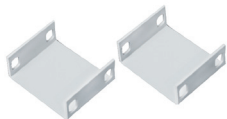

AD-19/19/1U/50

PO-1 PATCHCORD MANAGEMENT SHELF

- auxiliary accessory for PS-19 patch panels with 200 mm depth
- protects patchcords plugged in the adapter plate against accidental damage
- depth 85 mm
- fixing with adapter plate fixing screws
- no additional fixing components required

PO-2 PATCHCORD MANAGEMENT SHELF

- auxiliary accessory for PS-19 patch panels with 200 mm depth
- protects patchcords plugged in the adapter plate against accidental damage
- provides management of patchcords routed to the shelf installed under the patch panel
- depth 85 mm
- fixing with adapter plate fixing screws
- no additional fixing components required

Notice: all installation kits are dedicated for 19" racks

ORDERING:

PO-1 - Patchcord Management Shelf



PO-1



PO-2